

What's in the box

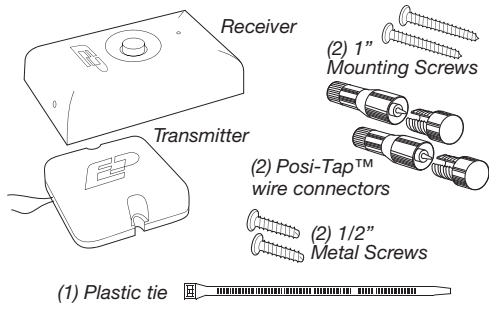

Tools needed



NOTE: If you decide to mount the transmitter with self-tapping metal screws to a metal body panel you will need a drill and 7/64" bit.

Easy and Safe to Install

The receiver and the transmitter are low voltage. You are never working with 120 volt household current. Also both installations are 'non-polarized' connections. You do not need to worry about one wire being 'positive' or 'negative' - you can't make a mistake!

Easy Set Up Instructions

Set Up Overview - F2P RECEIVER

Inside your garage you have an existing switch or button you use to open your door when you are not in your car. Low voltage wires connect to it, which are either surface mounted on the wall or are inside the wall behind the button. You will unscrew and remove your existing button, and detach the two wires. Then you will connect those two wires to the F2P receiver, and mount it on the wall in place of the old switch.

Set Up Overview - F2P TRANSMITTER

Under the hood, you will locate the two wires that are connected to each of your two high beam headlights. On the more accessible side (left or right), you will attach the two wires from the transmitter to the headlight wires using the included wire connectors. Then using either the included plastic fastener or screws, you will secure the transmitter to the car.

Flash2Pass Compatibility.

The Flash2Pass transmitter works with almost all cars, trucks, motorcycles, snowmobiles, or any other vehicle with a 12 volt electrical system. Vehicles with the "flash to pass" feature allows the F2P transmitter to be operated anytime because power is continuously sent to the headlight high beam switch, usually located on the turn signal stalk. If pulling your turn signal switch toward you flashes your high beams, your vehicle has the "flash to pass" feature. If your vehicle does not have the "flash to pass" feature, headlights will have to be on to send power to the high beam switch for the Flash2Pass system to operate. The F2P receiver is compatible with most garage door /gate openers made since April 1982.



F2P Technologies

200 West Twelfth Street · Waynesboro, VA 22980
(866) 249-7427 · (540) 942-3500
www.f2ptechnologies.com

Do You Have More Vehicles?

You can get additional transmitters for your other vehicles so they can also operate your garage door.

Do You Have A Vacation Home Or Entry Gate?

You can get extra receivers that will operate from the transmitter in your car. See your local retailer or order direct at www.f2ptechnologies.com.

Need More Help?

Call Toll-Free
866-249-7427



Our Tech Team is Here For You!

Caution: Unplug the garage door opener from the outlet or turn off its power at the fuse box / electrical panel.

1- Prepare the Receiver by carefully removing its back plate with a flat blade screwdriver.

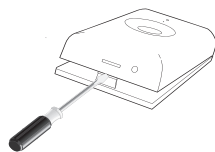

2- Find the existing opener button (switch). It is typically located near your inside door and will look similar to one of these:



3- Remove the screws holding the old button to the wall. In some cases you may need to snap off the faceplate to access the screws. You will find two wires attached to the back. Remove the wires from the button.

If your old inside switch has other functions and/or more than two wires - See FAQ.

4- Pass the two wires from the wall through the backing plate. Secure the plate to the wall with supplied screws

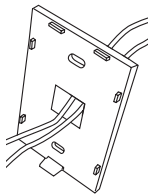

being careful not to pinch or screw through the wires.

Connect the two wires to your new F2P Receiver. No need to worry about + or - polarity; you can connect either wire to either terminal. Snap the front of the receiver to its back plate.

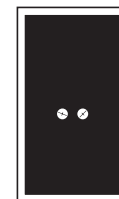

5- Restore power to the opener. The LED will be blinking.

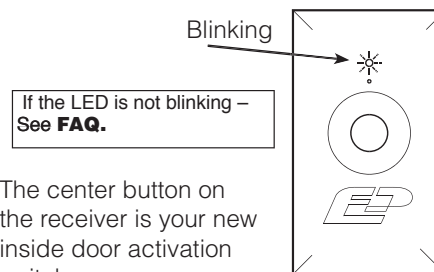

If the LED is not blinking - See FAQ.

The center button on the receiver is your new inside door activation switch.

The receiver installation is complete!

1- Look at the front of your car and determine which one of the four types of headlight configurations you have:

A) 4 separate round or square headlights.

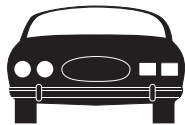

B) Newer aerodynamic headlights. Similar to A, this has 4 separate headlight bulbs, but they are beneath an outer lens.



C) 2 headlights, where each round or square sealed beam unit has both the high and low beam.

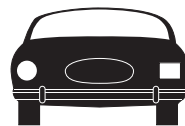

D) Newer aerodynamic headlight system. Similar to C, but the bulb is beneath an outer lens.



2- Look under the hood.

Determine whether the left or right side has more working room near the headlight. You may install the transmitter on the most convenient side.

a. If you have headlight configuration **(A)** or **(B)**, on each side you will find 2 sets of wires with 2 wires to each headlight.

Operate your lights and identify which are the high beams. You will attach the 2 wires of the transmitter to the 2 wires leading to the high beam light.

If you found the high beam headlight, but there are more than two wires attached to it - See FAQ.

b. If you have **(C)**, you will find one set of 3 wires to each headlight. The connector will look like this. You will connect the transmitter to the 2 wires indicated to the right.

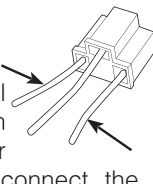

c. If you have **(D)**, you will find one set of 3 wires to each headlight. You may determine which 2 wires power the high beam with a test light, or go to our website and use our application guide which will show which wires to use for your vehicle's year, make, and model.

3- Use the included Posi-Tap™ connectors to attach the transmitter to the two headlight wires.

Posi-Tap™ Instructions

1. Insert

The headlight wire to be tapped.



2. Tighten

The body of the Posi-Tap.



3. Strip 3/8"

Both Flash2Pass transmitter wires.



4. Insert & Tighten

Cap of Posi-Tap with transmitter wires.

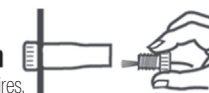

4- WARNING: Be Sure That The Garage Door Is Always In Sight Before Operating Opener!



5- Before securing the transmitter to the car, test the system. With the hood open and the car off, flash the high beams ON-OFF-ON. The door will open (or close).

If the door does not work - See FAQ.

6- Remove or reposition anything that could contact moving parts when you start your car. Close the hood and move your vehicle to where you would typically use the opener. Now operate the opener to test the range.

If the range is inadequate - See FAQ.

7- You can secure the transmitter to the car with either the two screws or plastic tie (included).



a. Plastic tie: attach to any convenient location except where there are moving parts or excessive heat, (for example: engine, belts, radiator, hoses).

b. Screws: find a suitable location to drill the holes (7/64") that will not damage any part of the car including wiring, hoses, fuel or brake lines, etc.

Congratulations!

Your installation is complete. To use your Flash2Pass system, simply flash your high beams twice to activate your garage door. The Flash2Pass does not require any further set-up or maintenance.

FAQ: Frequently Asked Questions

Q: My existing inside garage door opener switch has other functions and/or more than 2 wires:

A: 1 - If it has more than two wires, you will use the positive terminal for the garage door opener and the common ground terminal. If you want to keep the other functions, for example, separate light switch or lock: You will leave the existing switch in place, attaching 'jumper wires' (not included) from it to the F2P receiver, which you will mount next to your old switch. OR You can connect the F2P receiver with 'jumper wires' directly to the terminals on the opener itself where the wires to the existing switch are connected. Then secure the receiver at least 10" away from the door opener. Both your wall switch and the F2P receiver will function normally. 2 - If you do not use the other functions, or you want to discontinue the use of the other functions, remove the old unit, and determine which wire is the common ground and which of the others control the opener. Attach these two wires to the F2P receiver,

and separately wrap the other wires with electrical tape and twist them out of the way.

Q: The LED is not blinking after I restored the power to the opener:

A: 1- Verify door activation with the old handheld remote. If it does not work power has not been restored to the opener. 2- Some basic or older systems do not have adequate power to the inside switch. In these rare instances you will need an external power adapter. Simply call our customer service department at 866-249-7427. We offer one, and will send it to you with no shipping and handling charge. Please have your receipt available when you call.

Q: If you found the high beam headlight, but there are more than two wires attached to it:

A: Some cars (particularly German), have a multi-wire harness that plugs into the head light assembly. Either call F2P customer service or go to our web site and use our application guide which will show which wires to use for your vehicle.

Q: The LED blinks but the door does not work with transmitter activation:

A: 1- Recheck the transmitter's connections. Make sure the pin has pierced the headlight wire and the transmitter's wires are fully seated.

2 - Verify the transmitter is connected only to the two headlight wires. Do not chassis ground the transmitter.

Q: Transmitter range is inadequate:

A: This product is designed to have an operating range of approx 75' when installed under the hood of a car. Range is reduced primarily by excessive metal shielding. We recommend you temporarily reposition transmitter under the hood closer to the front grill and verify acceptable performance. Permanently reinstall the transmitter in a less metal obstructed area as needed.

Q: I want to deactivate a transmitter's code from the receiver because (for example) my car was stolen with the installed transmitter:

A: You can perform a 'total erase'. In the event the transmitter is lost or stolen, a receiver 'total erase' should be done. To enter the "erase" mode, locate the small hole on the front of the receiver cover located between the LED light and the push button. Gently push a paper clip through the hole, which will depress a hidden switch. To erase all transmitter codes from the receiver, press the push button until the LED flashes 4 times. Continue to hold in the button, the LED will flash 4 times again. All learned transmitter codes have now been erased. The remaining / new transmitters now need to be re-learned. To enter the "add" mode, depress the hidden switch. The LED will flash 4 times. Remove the paper clip. Activate the transmitter within 30 seconds. The LED will begin flashing normally. Test the new transmitter. Repeat the same simple process with up to 5 additional transmitters.

